

## ■Features

- Full-Color
- Super high brightness of surface mount LED
- Water Clear Flat Mold
- Compact package outline  
(LxWxT) of 3.2mm x 2.7mm x 0.8mm
- Compatible to IR reflow soldering.

## ■Applications

- Backlighting (switches, keys, etc.)
- Marker lights (e.g. steps, exit ways, etc.)

## ■Outline Dimension

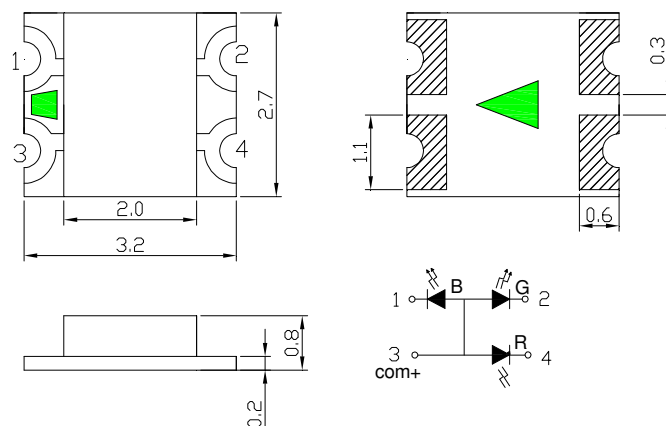

Notes: 1. All dimensions are in millimeters ;  
2. Tolerance is  $\pm 0.10$  mm unless otherwise noted.

## ■Absolute Maximum Rating

(Ta=25°C)

Item	Symbol	Value		Unit
		Red	G/B	
DC Forward Current	$I_F$	30	30	mA
Pulse Forward Current*	$I_{FP}$	70	100	mA
Reverse Voltage	$V_R$	5	5	V
Power Dissipation	$P_D$	78	108	mW
Operating Temperature	$T_{opr}$	-25 ~ +85		°C
Storage Temperature	$T_{stg}$	-35 ~ +85		°C
Lead Soldering Temperature	$T_{sol}$	260°C/5sec		-

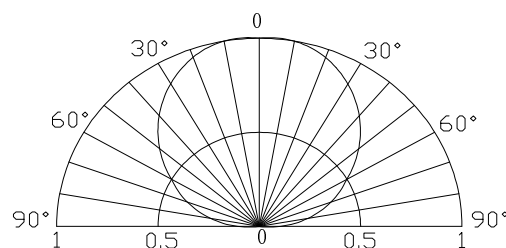

\*Pulse width Max 0.1ms, Duty ratio max 1/10

## ■Directivity



## ■Electrical -Optical Characteristics

(Ta=25°C)

Part Number	Color			$V_F$ (V)			$I_R$ (μA)	$I_v$ (mcd)			$\lambda_D$ (nm)			2θ1/2(deg)
				Min.	Typ.	Max.	Max.	Min.	Typ.	Max.	Min.	Typ.	Max.	Typ.
				$I_F=20\text{mA}$			$V_R=5\text{V}$	$I_F=20\text{mA}$			$I_F=20\text{mA}$			
OSTB3227C1C-A	Blue	BL		2.8	3.1	3.6	10	-	90	-	465	470	475	120
	Pure Green	PG		2.8	3.1	3.6	10	-	300	-	520	525	530	120
	Red	HR		1.8	2.1	2.6	10	-	100	-	620	625	630	120

\*1 Tolerance of measurements of dominant wavelength is  $\pm 1\text{nm}$

\*2 Tolerance of measurements of luminous intensity is  $\pm 15\%$

\*3 Tolerance of measurements of forward voltage is  $\pm 0.1\text{V}$