

Descriptions:

- Voltage available in **DC10V**
- LED Type: 1W Xeon Power LED
- MCPCB
- Lens OS-OLSH6620P available

Application:

- Small Space Lighting
- Mechanical equipment lights

Photo



Outline Dimension

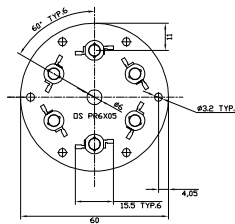

Circuit Diagram

Constant Current 700mA

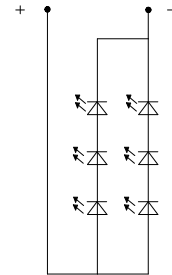

Unit: mm
Tolerance: $\pm 0.3\text{mm}$

Typical Performance (Ta=25°C)

Items	Symbol	Min.	Typ.	Max.	Units
LED Module Power	Pm(B, W, G)	-	7.0	9.6	W
	Pm(R, Y)	-	5.3	7.2	
Input Voltage(DC)	Vi(B, W, G)	-	10	12	V
	Vi (R, Y)	-	7.5	9.0	
Product Input Current	If	-	700	800	mA
Beam Pattern	BP	-	140	-	Deg
Operating Temperature	Topr	-30	-	85	°C
Storage Temperature	Tstg	-40	-	100	°C
PCB Diameter	Lmod.	-	60	-	mm

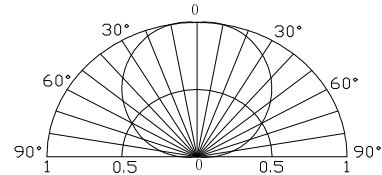

Device Selection Guide

Module No.	Color	Wavelength(Typ.)		Condition	Overall Luminous Flux (Typ.)
OSPR6XR5-R5XNE1E1E	Red	625 nm		IF=700mA	300 lm
OSPR6XG5-G5XNE1E1E	Pure Green	525 nm		IF=700mA	450 lm
OSPR6XB5-B4XNE1E1E	Blue	460 nm		IF=700mA	90 lm
OSPR6XY5-Y5XNE1E1E	Yellow	590 nm		IF=700mA	300 lm
OSPR6XW5-W4XNE1E1E	White	X=0.31, Y=0.33	6500K	IF=700mA	600 lm
OSPR6XM5-M5XNE1E1E	Warm White	X=0.45, Y=0.41	3000K	IF=700mA	540 lm