

## ■Features

- High Luminous PLCC8 Top SMD LEDs
- 5.0x5.0x1.6mm Standard Directivity
- Superior Weather-resistance
- UV Resistant Epoxy
- Water Clear Type

## ■Applications

- Toys/Games/Audio
- Small Area Illuminations
- Back Lighting/Other Lighting

## ■Outline Dimension

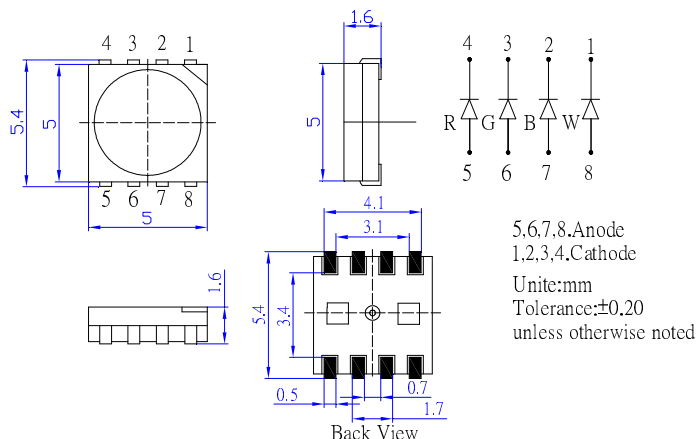

## ■Absolute Maximum Rating

(Ta=25°C)

Item	Symbol	Value		Unit
		Red	G/B/W	
DC Forward Current	$I_F$	50	30	mA
Pulse Forward Current*	$I_{FP}$	120	100	mA
Reverse Voltage	$V_R$	5	5	V
Power Dissipation	$P_D$	130	114	mW
Operating Temperature	$T_{opr}$	-30 ~ +85		°C
Storage Temperature	$T_{stg}$	-40 ~ +100		°C
Lead Soldering Temperature	$T_{sol}$	260°C/10sec		-

\*Pulse width Max.10ms Duty ratio max 1/10

## ■Directivity

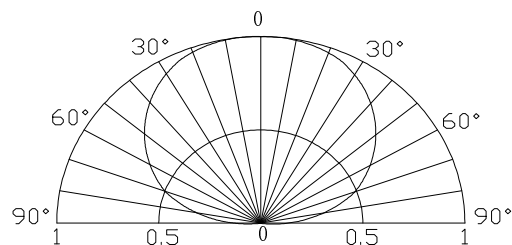

## ■Electrical -Optical Characteristics

(Ta=25°C)

Item	Symbol	Condition	Min.	Typ.	Max.	Unit
DC Forward Voltage	$V_F(R)$	$I_F=20mA$	1.8	2.1	2.6	V
	$V_F(B/G)$	$I_F=20mA$	2.8	3.1	3.6	V
	$V_F(W)$	$I_F=20mA$	2.8	3.1	3.6	V
DC Reverse Current	$I_R$	$V_R=5V$	-	-	10	μA
Domi. Wavelength*	$\lambda_D(Red)$	$I_F=20mA$	620	625	630	nm
	$\lambda_D(Green)$	$I_F=20mA$	520	525	530	nm
	$\lambda_D(Blue)$	$I_F=20mA$	465	470	475	nm
	CCT (W)	$I_F=20mA$	5500	6500	7500	K
Luminous Intensity*	$I_v(Red)$	$I_F=20mA$	500	750	-	mcd
	$I_v(Green)$	$I_F=20mA$	900	1120	-	mcd
	$I_v(Blue)$	$I_F=20mA$	330	500	-	mcd
	$I_v(W)$	$I_F=20mA$	1600	2000	-	mcd
50% Power Angle	$2\theta_{1/2}$	$I_F=20mA$	-	140	-	deg

\*1 Tolerance of measurements of chromaticity coordinate is ±10%

\*2 Tolerance of measurements of dominant wavelength is ±1nm

\*3 Tolerance of measurements of luminous intensity is ±15%

\*4 Tolerance of measurements of forward voltage is ±0.1V