

■ Features

- High Luminous LEDs
- 5mm Round Standard Directivity
- Superior Weather-resistance
- UV Resistant Epoxy
- Color Diffused Type
- **Stanley: 5334 Series**

■ Applications

- Electronic Signs And Signals
- Small Area Illuminations
- Back Lighting
- Other Lighting

■ Outline Dimension

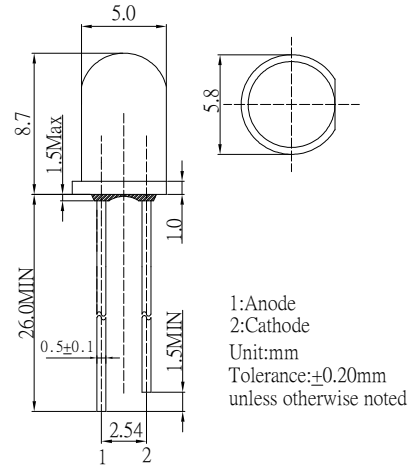

■ Absolute Maximum Rating (Ta=25°C)





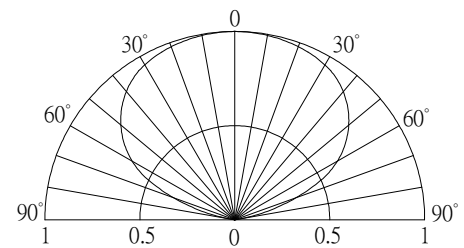

Item	Symbol	Value	Unit
		YG/Y/O/R	
DC Forward Current	I _F	30	mA
Pulse Forward Current*	I _{FP}	100	mA
Reverse Voltage	V _R	5	V
Power Dissipation	P _D	78	mW
Operating Temperature	T _{opr}	-30 ~ +85	°C
Storage Temperature	T _{stg}	-40 ~ +100	°C
Lead Soldering Temperature	T _{sol}	260°C/5sec	-

■ Directivity



*Pulse width Max.10ms Duty ratio max 1/10

■ Electrical -Optical Characteristics (Ta=25°C)

Part Number	Color			V _F (V)			I _R (μA)	I _v (mcd)			W _d (nm)*			2θ _{1/2} (deg)
				Min.	Typ.	Max.	Max.	Min.	Typ.	Max.	Min.	Typ.	Max.	Typ.
				I _F =20mA			V _R =5V	I _F =20mA						
OSG8NU5AD4A	Yellow Green	YG		1.8	2.1	2.6	10	20	30	-	565	570	575	130
OSY5LU5AD4A	Yellow	Y		1.8	2.1	2.6	10	45	68	-	585	590	595	130
OSY5JA5AD4A	Yellow	Y		1.8	2.1	2.6	10	68	100	-	585	590	595	130
OSO5JA5AD4A	Orange	O		1.8	2.1	2.6	10	100	150	-	600	605	610	130
OSR5JA5AD4A	Red	R		1.8	2.1	2.6	10	68	100	-	620	625	630	130
OSR6LU5AD4A	Red	R		1.8	2.1	2.6	10	30	45	-	630	640	650	130

*1 Tolerance of measurements of dominant wavelength is ±1nm

*2 Tolerance of measurements of luminous intensity is ±15%

*3 Tolerance of measurements of forward voltage is ±0.1V